

digiLED iCube

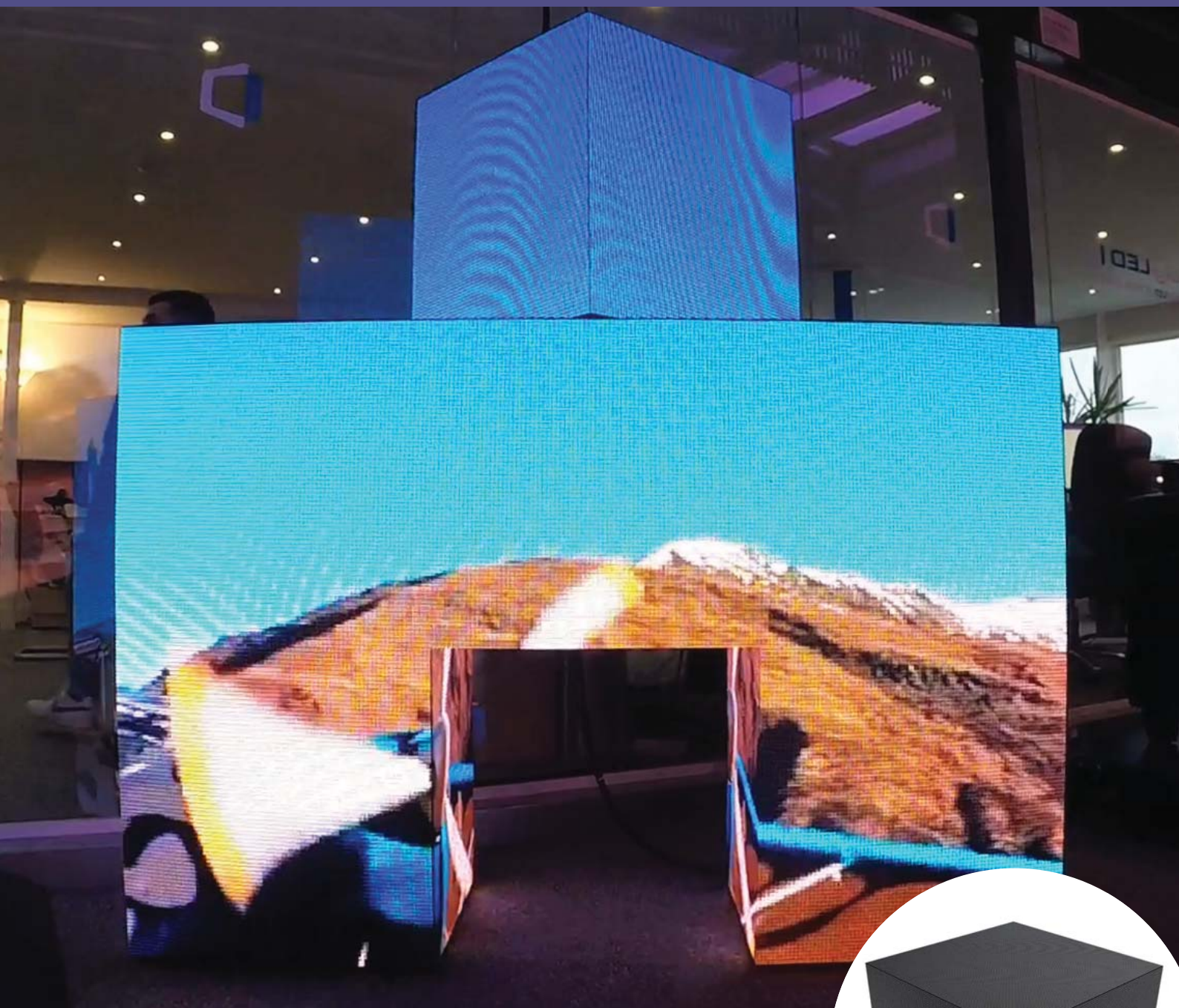

Ingenious design allowing seamless cornering on all six sides for an all round image area. Use as separate facets or run your content as one across all six faces. Easy to put together, versatile and creative, the iCube offers a new twist to POS, exhibition, art or any unique visual display.

iCube is a comfortable pixel pitch at 3.9mm so is ideal for medium viewing distances. Front serviceable, so you don't have to dismantle the whole screen set up to make any changes. Optimum colour for pure and clean imagery with great contrast.

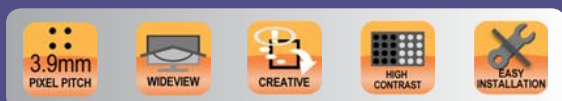

digiLED iCube MODULE SPECIFICATIONS

iCube 3900

LEDS		
Physical Pixel Pitch (HxV)	mm	3.906
LEDs Per Pixel		1R1G1B
Red Wavelength (Dominant)	nm	620
Green Wavelength (Dominant)	nm	520
Blue Wavelength (Dominant)	nm	465
PIXELS		
Pixel Configuration		SMD 3-in-1
LED Face Colour		Black body or Total Black
Physical Pixel Resolution (Width)	pixels/module	128
Physical Pixel Resolution (Height)	pixels/module	128
Physical Pixels Per Area (std module)	pixels/m2	65,536
MODULE		
Standard Active Module Width	mm	500
Standard Active Module Height	mm	500
Active Module Area	m2	0.25
Cube Assembled Size	mm	503 x 503 x 516
Module Weight	kg	7.12
Viewing Angle - Horizontal	degrees	>160
Viewing Angle - Vertical	degrees	>160
Ingress Protection	(Front)	IP43
Ingress Protection	(Back)	IP43
Surface Finish		Die-Cast Aluminium
LED Fixings		Front or Rear access
Storage Temperature Range	degree C	-10 to +40
Operating Temperature Range	degree C	-30 to +60
Operating Humidity Range	%	10 to 90 Non-condensing
COLOUR		
Greyscale Processing Depth	bits	16
Number of Colours		281 trillion
Refresh Rate	Hz	>1,920 to 3,840
BRIGHTNESS		
Brightness (Before Calibration)	nits	>1,200
Brightness Control		Auto/Manual
Contrast ratio		4,000:1
POWER		
Input Voltage	VAC	110~230
Input Power (Average)	watts/module	21
Input Power (Maximum)	watts/module	70
OTHER		
Lifespan	hours	>100,000
Computer System Type		PC Win7, Vista, XP, WIN2000
Video Input		DVI, HDMI
Connectors		Genuine Neutrik PowerCon True1 & EtherCon USB and RJ45
Control System		NovaStar
Stacking	Max number of modules	12
Certification		CE, EMC (class A), RoHS
All specifications are correct at time of print, however they are liable to change and should be confirmed at point of order		

